

PN330

The AIMWIN PN330 Open Reflex Sight is specially designed for pistols, featuring a 2 MOA dot and a 32 MOA circle. It is available with 11 brightness settings and multiple reticle options.

Powered by a CR2032 lithium coin battery, it provides a max runtime of 20,000h. Thanks to a motion sensor, it will automatically activate and access the previous memorized brightness level when detecting any movement in Standby Mode. The durable housing is constructed from aluminum alloy A7075-T6 with a hard-anodized finish.

Dimensions



Package List

- CR2032 Battery
- Lens Cloth
- User Manual
- L-Shaped Wrench x 2
- Screw (S/M/L) x 4

FEATURES



2 MOA Dot Size & 32 MOA Circle Size



Multiple Reticle Options



Motion Sensor
For Automatic Activation



Aluminum Alloy A7075-T6

11 Brightness Settings



MotionWake Technology
Motion Sensing Activation



Parallax Free



Aluminum Alloy
A7075-T6

1. MotionWake Technology:
 - a. The PN330 will automatically access the Standby Mode if there is no movement for 5 minutes.
 - b. When detecting any movement in the Standby Mode, it will access the previous memorized brightness level.
2. Parallax Free
3. Aluminum Alloy A7075-T6

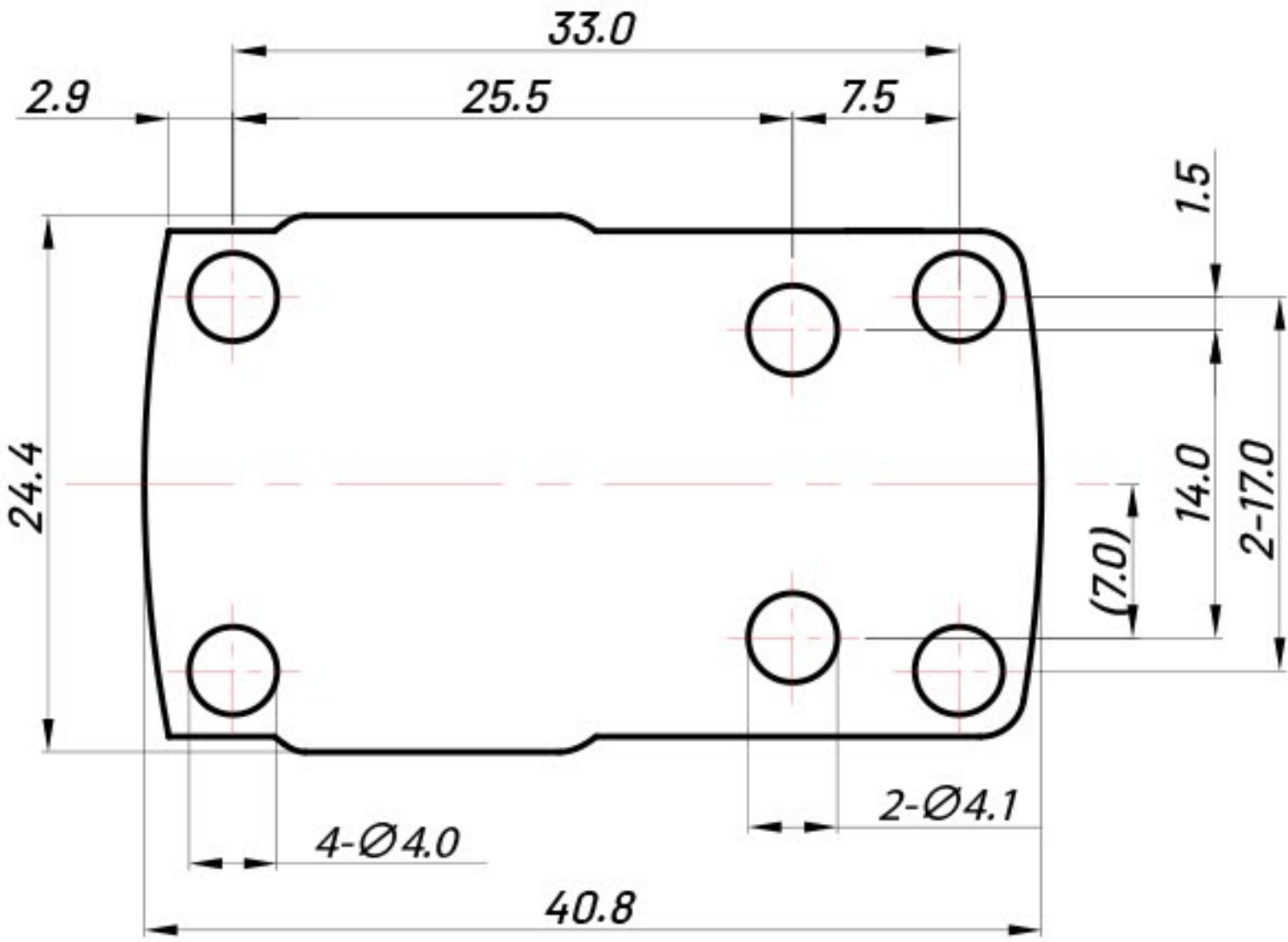

Footprint

SPECIFICATIONS

Dot Size	2 MOA	Window Size	22.0mm x 16.5mm
Circle Size	32 MOA		(0.87" x 0.65")
Reticle Color	Red	Dimensions	40.8mm x 27.0mm x 24.4mm
Light Wavelength	650nm		(1.61" x 1.06" x 0.96")
Parallax	Parallax Free	Weight	23g (0.81 oz) (Battery Included)
Magnification	1x	Housing Material	Aluminum Alloy A7075-T6
Windage & Elevation Travel Range	±45 MOA	Surface Finish	Hard-anodized
Battery	CR2032	Footprint	RMS-C
Battery Life	20,000h	Operating Temperature	-20°C~60°C
Brightness Settings	9 Daylight Levels		(-4°F~140°F)
	2 Night Vision Levels	Water Resistance	IPX7
		Vibration	2,000G